

522 Globe Lane

ARCHITECTURAL EMPORIUM Ltd
EMAIL: mail@architectural-emporium.co.uk
WEB: www.architectural-emporium.co.uk
ADDRESS: 13 Hope St, Liverpool, L1 9BQ
PHONE: +44 (0)151 363 0000

0 1 5 10 20 1:200

North Point

Site Boundary

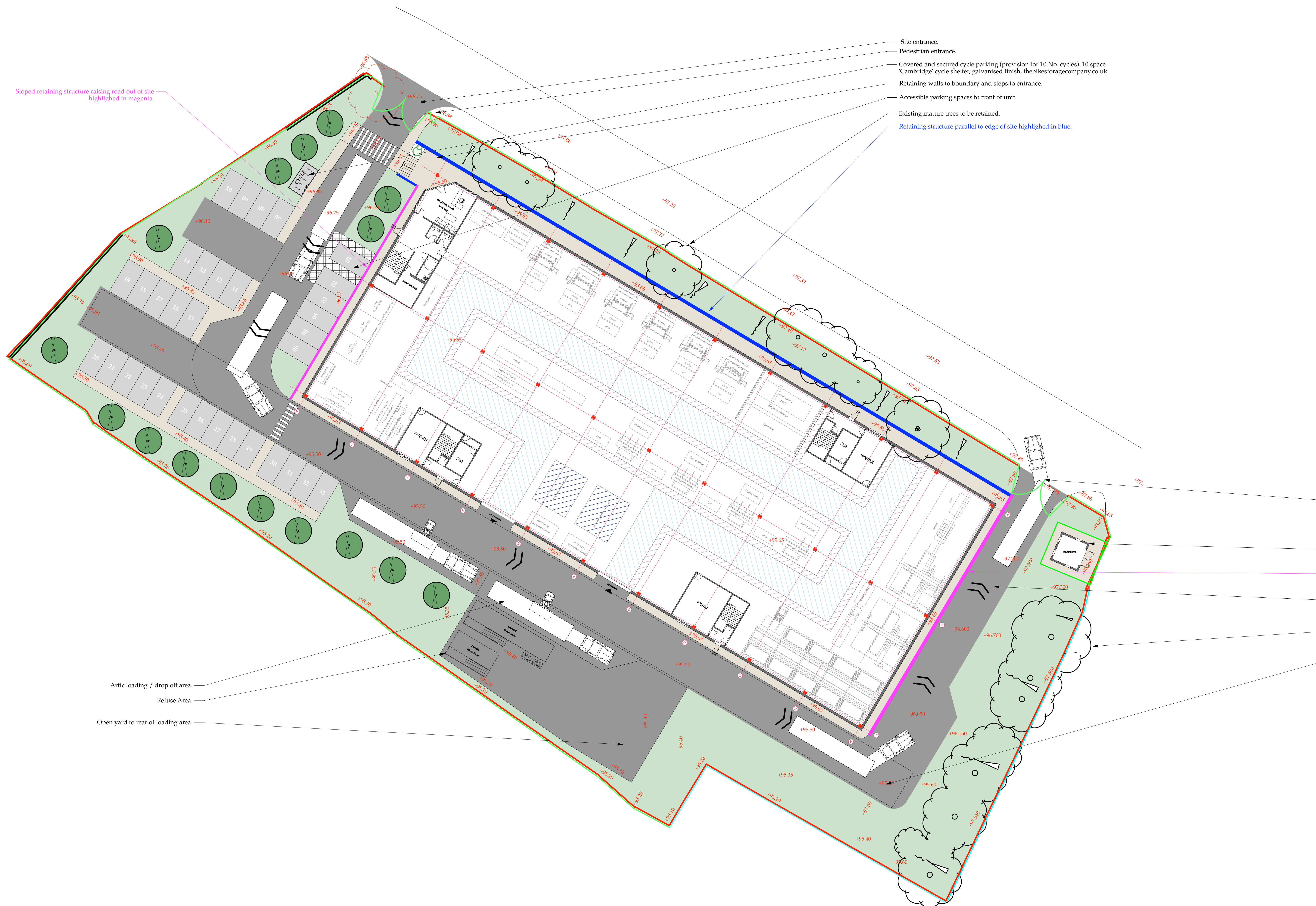

Sloped retaining structure raising road out of site highlighted in magenta.

- Site entrance.
- Pedestrian entrance.
- Covered and secured cycle parking (provision for 10 No. cycles), 10 space Cambridge cycle shelter, galvanised finish, thebikesstoragecompany.co.uk.
- Retaining walls to boundary and steps to entrance.
- Accessible parking spaces to front of unit.
- Existing mature trees to be retained.
- Retaining structure parallel to edge of site highlighted in blue.

- Artic loading / drop off area.
- Refuse Area.
- Open yard to rear of loading area.

- Site exit.
- New Substation to corner of site with external access as indicated.
- Sloped retaining structure raising road out of site highlighted in magenta.
- One way traffic through site.
- Existing mature trees to be retained.
- Corners widened to allow Arctic Tracking.

Rev D: 03.04.23
Page size and scale amended, substation added and Refuse Area Updated. Proposed Levels and interior detail added.

FOR: PLANNING
CHECKED BY: AJ DRAWN BY: MS
SCALE: 1:200
PAPER SIZE: A0
JOB: 522 GLOBE LANE

2.100_Rev D
FIRST ISSUE: 31.10.11
PROPOSED GROUND FLOOR PLAN